



FIRST GALENA
 GOLF PERFORMANCE STUDIOS
Built Better, Built Faster

COTTAGE SINGLE BAY

Rendering may contain optional features

Year Round Golf Experience

Take golf to the next level “year round” with one of First Galena’s Golf Performance Studios. These modular buildings are delivered “turn-key” with the latest golf technology of your choice. Play 18 holes on the simulator, teach lessons using motion & video analysis, fit golf clubs using a launch monitor, hit balls from inside out onto a driving range, it’s all possible with our studio designs.

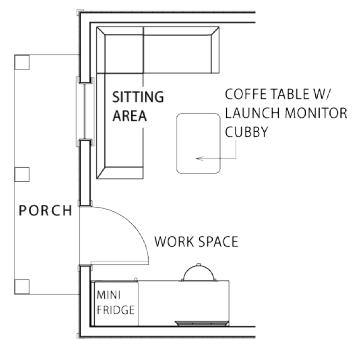

OPTION A

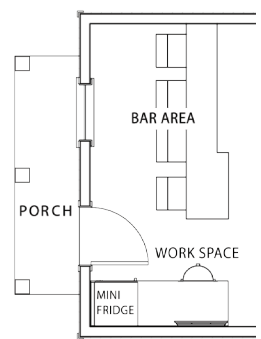

OPTION B

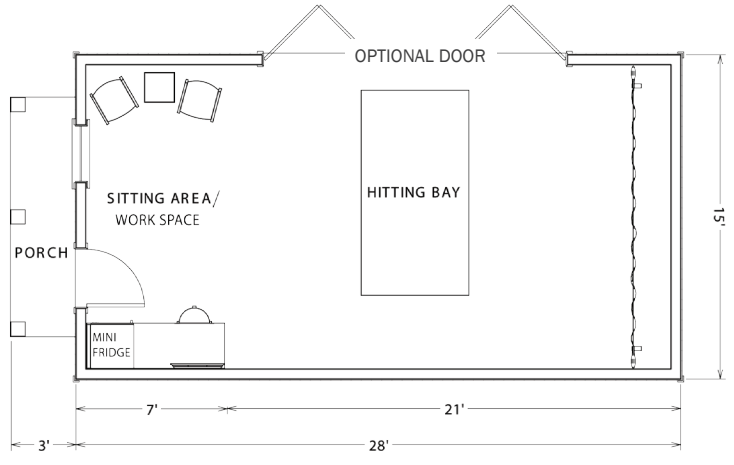

NATHAN STUDTMANN
 SALES MANAGER.DESIGNER.PGA



COTTAGE -1 BAY

STANDARD SPECIFICATIONS

FLOORS AND CEILINGS

Patented truss floor system
Perimeter girder beams
Enclosed insulated floor system (R-25)
Duradeck® vinyl on porch floor
Detachable hitch
3/4" Tongue and groove oriented strand board
Owens Corning® fiberglass ceiling insulation (R-30)
10' ceiling in hitting bay

ROOF

24" O.C. roof trusses
1/2" ZIP® system roof sheathing
GAF® Timberline HD Lifetime shingles
Aluminum soffit and fascia

EXTERIOR WALLS

2" x 6" studs - 16" O.C.
2" x 6" plates - double top plate/single plate
at bottom
7/16" ZIP® system sheathing glued and stapled
CertainTeed® Mainstreet vinyl siding w/ LP Smartside trim
Owens Corning® fiberglass wall insulation (R-21)
*Optional LP Smartside® siding package

FLOOR COVERING

Indoor-outdoor carpet
(1) 10' x 5' Real Feel Golf Mat® recessed into floor
*Optional rubber floor
*Optional Quick & True® putting turf

INTERIOR

Nudo® protective wall and ceiling panels
Slat board wall panels
Painted white trim package
Merillat® Basics Wesley computer cabinet at desk
Laminate countertop
*Optional raised bar w/ bar stools
*Optional sofa & custom coffee table

WINDOWS AND DOORS

Vinyl (Low-E) windows with screens and grids
Fiberglass entry door with aluminum cladding
Schlage® door lockset
Retractable netting
*Optional Weather Master Plus® stacking door system
*Optional retractable simulator projection screen
*Optional electronic blinds on windows
*Optional August® smart lock

HEATING/COOLING

Amana PTAC Heat & AC
*Optional Nest® learning thermostat

LIGHTING

(2) Recessed lights on porch
(10) Dimmable LED recessed lights inside studio
*Optional flood lights at rear of building

ELECTRICAL

100 Amp Cutler Hammer® Panel Box
GFCI protected outlets-exterior front and rear
Smurf tubing to run equipment wiring
*Optional equipment packages
*Optional floor monitors
*Optional fans
*Optional refrigerator



OUTDOOR/INDOOR INSTRUCTION



PORTABLE



STATE OF THE ART TECHNOLOGY

OFFICE 815.777.4700 | FAX 815.777.1541 | WWW.FIRSTGALENA.COM

9332 HWY 20 W. GALENA, IL 61036