

Rendering may contain optional features



FIRST GALENA
GOLF PERFORMANCE STUDIOS
Built Better, Built Faster

CRAFTSMAN DOUBLE BAY

Year Round Golf Experience

Take golf to the next level “year round” with one of First Galena’s Golf Performance Studios. These modular buildings are delivered “turn-key” with the latest golf technology of your choice. Play 18 holes on the simulator, teach lessons using motion & video analysis, fit golf clubs using a launch monitor, hit balls from inside out onto a driving range, it’s all possible with our studio designs.

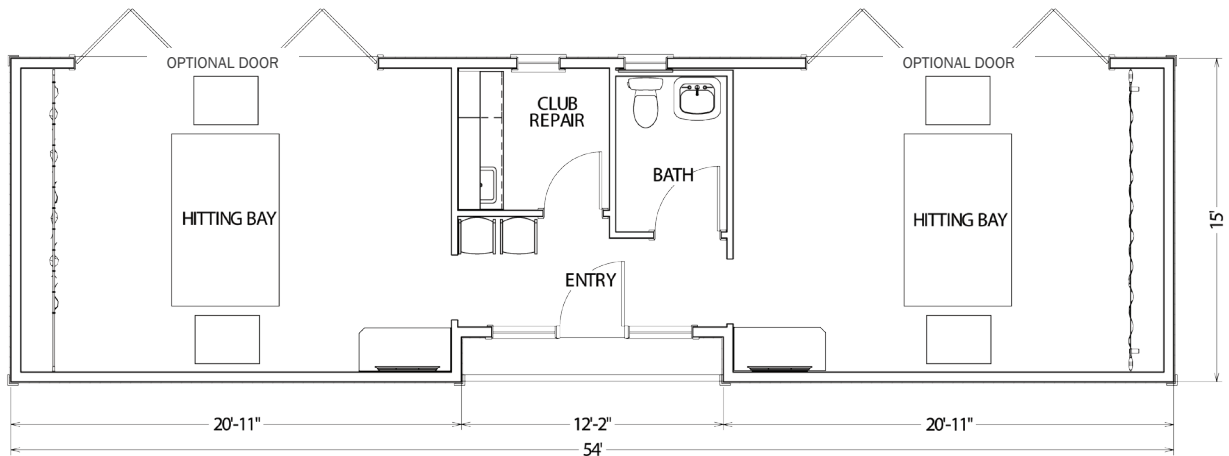

NATHAN STUDTMANN
SALES MANAGER.DESIGNER.PGA



CRAFTSMAN -2 BAY

STANDARD SPECIFICATIONS

FLOORS AND CEILINGS

Patented truss floor system
Perimeter girder beams
Enclosed insulated floor system (R-25)
Duradeck® vinyl on porch floor
Detachable hitch
3/4" Tongue and groove oriented strand board
Owens Corning® fiberglass ceiling insulation (R-30)
10' ceiling in hitting bays

ROOF

24" O.C. roof trusses
1/2" ZIP® system roof sheeting
GAF® Timberline HD Lifetime shingles
Aluminum soffit and fascia
*Optional cupola on roof

EXTERIOR WALLS

2" x 6" studs - 16" O.C.
2" x 6" plates - double top plate/single plate at bottom
7/16" ZIP® system sheeting glued and stapled
CertainTeed® Mainstreet vinyl siding w/ LP Smartside trim
Owens Corning® fiberglass wall insulation (R-21)
*Optional LP Smartside® siding package
*Optional signage

FLOOR COVERING

Indoor-outdoor carpet in hitting bays
(2) 8' x 5' Real Feel Golf Mat® recessed into floor
Earthwerks® luxury vinyl plank flooring in entry, bath, and club repair
*Optional rubber floor in hitting bays

HEATING/COOLING

Fujitsu® ductless mini-split heat and AC
*Optional Nest® learning thermostat

INTERIOR

Nudo® protective wall and ceiling panels
Slat board wall panels
Painted white trim package
Merillat® Basics Wesley cabinets
Wire shelving in storage room
Laminate countertops
Pre-finished white solid core door

WINDOWS AND DOORS

Vinyl (Low-E) windows with screens and grids
Fiberglass entry door with aluminum cladding
Sidelights around entry door
Schlage® door lockset
Retractable netting
*Optional Weather Master Plus® stacking door system
*Optional retractable simulator projection screen
*Optional electronic blinds on windows
*Optional August® smart lock

LIGHTING

(2) Recessed LED lights at front door
(2) Coach lights on each side of entry
(10) Dimmable LED recessed lights inside both studios
*Optional flood lights at rear of building

ELECTRICAL

100 Amp Cutler Hammer® Panel Box
GFCI protected outlets-exterior front and rear
Smurf tubing to run equipment wiring
*Optional equipment packages
*Optional floor monitors
*Optional fans

PLUMBING

ADA sink and toilet in bath
Utility sink in club repair room
Uponor® PEX water line system
PVC drain,waste, and vent systems
Built in 30 gal hot water system



OUTDOOR/INDOOR INSTRUCTION



PORTABLE



STATE OF THE ART TECHNOLOGY

OFFICE 815.777.4700 | FAX 815.777.1541 | WWW.FIRSTGALENA.COM

9332 HWY 20 W. GALENA, IL 61036