

The Zion

a luxurious recreational retreat

Fun Fact
The narrowest section of Zion Canyon is only 20-feet wide with 1000-foot high cliffs on each side. There is no trail, so hikers have to wade through a river to reach it.



Plans and elevations may contain options which are not standard on all models

The Zion (zai-aan), with its high walled red colored canyons, defines this home design. Just as the narrow canyons of Zion National Park are worth hours of wading through rivers to reach, this home will be a focal point of future experiences. By having an efficient layout, The Zion maximizes light and airy spaces throughout. A 3-panel sliding glass door forms the entryway to the living room and kitchen with vaulted ceilings. The kitchen has a rolling island, designed to stow away and maximize space in the living room. Off the living room, is an 8-foot wide covered deck with a wall that forms a wind shelter. There is also a bonus space, which can be used as two-bunk beds, a stacked washer & dryer, or a workspace. If you choose to add the bunk beds, this home can comfortably sleep 6-people. With such a commanding front facade, this home has unprecedented curb appeal.

Unique Features

- 400 sq. ft. main floor, 97 sq. ft. of deck, 92 sq. ft. of loft, 589 sq. ft. total
- vaulted ceilings throughout the living space
- maintenance free siding
- large covered deck with wind shelter
- master bedroom with closet
- full-size bath
- two bedrooms with queen beds
- horseshoe style kitchen with rolling island
- comfortable circulating heating and cooling
- much more...

Typical "UV" Construction Features

- patented #6018921 insulated floor system
- 2x4 exterior wall construction with ZIP system sheathing
- closed cell spray foam in floor, walls, and ceilings
- factory prefinished siding
- Pella windows and doors
- drywall walls with wood accents
- Kohler plumbing products
- LED lighting
- Merillat cabinets
- quartz countertops
- Whirlpool appliances
- and more...



3123 S. Memorial Drive | Mt. Pleasant, WI 53403 | 101 Parr Avenue | Spicewood, TX 78669

P: 414 . 762 . 0950 | F: 414 . 762 . 0955

sales@utopian-villas.com | utopian-villas.com



Rev. 3-20

The Zion Floor Plan



Main Floor

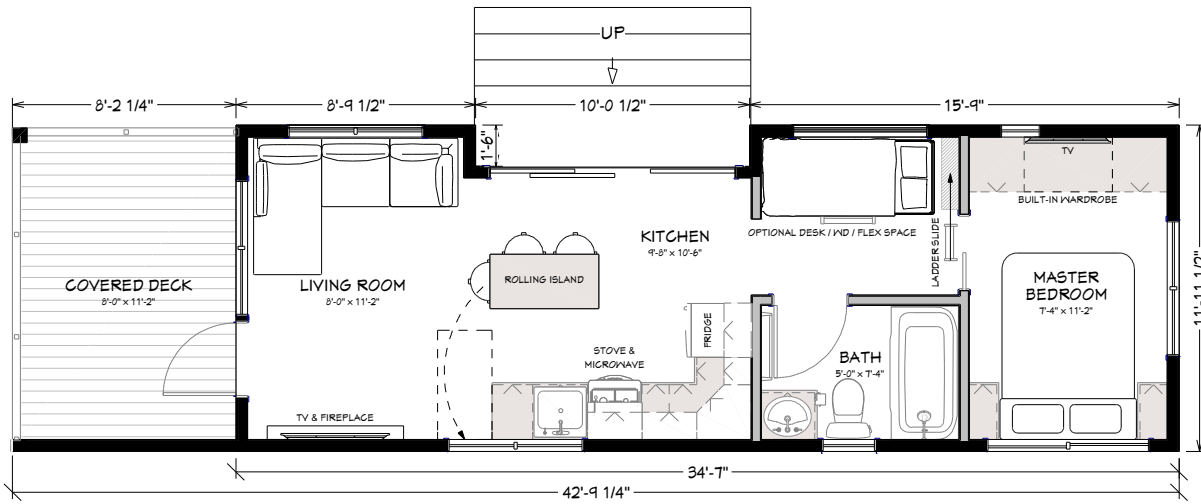

Loft

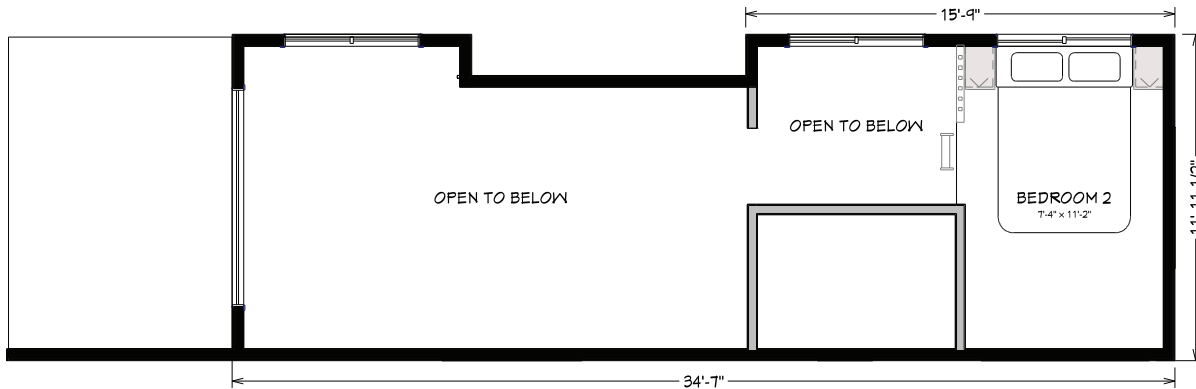

Utopian Villas reserves the right to make changes to the floorplans, specifications, dimensions and elevations without prior notice

3123 S. Memorial Drive | Mt. Pleasant, WI 53403 | 101 Parr Avenue | Spicewood, TX 78669

P: 414 . 762 . 0950 | F: 414 . 762 . 0955

sales@utopian-villas.com | utopian-villas.com



Rev. 3-20